

L&L LOUVERS INC.

12355 DOHERTY STREET
RIVERSIDE, CA. 92503
(951) 735-9300 FAX:(951)735-4628
E-MAIL: info@louver1.com

DOOR EDGES and ASTRAGALS

FABRICATION STANDARD FEATURES:

MATERIAL: 18 GAUGE JETKOTE

CONSTRUCTION: COUNTERSUNK MOUNTING HOLES

FINISH: DARK BRONZE OR GREY POWDER COAT

DOOR: FOR 1-3/4" THICK DOOR

FASTENERS: #8 X 3/4" FLATHEAD PHILLIPS HEAD SCREWS

OTHER OPTIONS:

MATERIALS: 18 GAUGE # 304 STAINLESS STEEL, #4 FINISH

FASTENERS: SPECIAL ORDER COLORS, COLOR CHIP MUST BE PROVIDED WITH ORDER. CALL FOR PRICING.

DOOR THICKNESS: CALL CUSTOMER SERVICE FOR SPECIAL PRICING.

HARDWARE PREPS: **CUTOUT HARDWARE DETAIL SHEET
MUST BE PROVIDED BEFORE ORDER
CAN BE RELEASED FOR PRODUCTION**

DE-90
Metal Edges (pair)
for 90° Doors

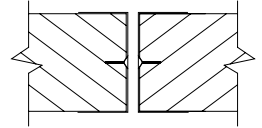

DE-90
Metal Edges (pair) with
Astragal for 90° Door

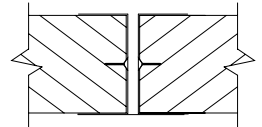

DE-905
Metal Edge with
Astragal for 90° Door

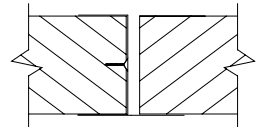

DE
Metal Edges (pair) for
Swinging Doors

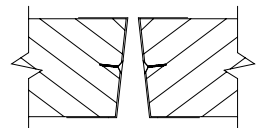

DEA
Door Edges (pair)
with Astragal for
Swinging Doors.

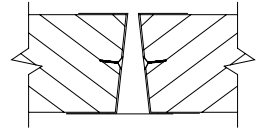

DEA-5
Metal Edges with
Astragal for
Swinging Doors.

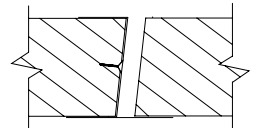

DE-DE
Metal Edges (pair)
for Double Egress
Door.

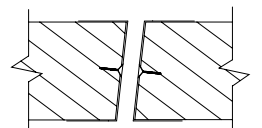

DEA-DE
Metal Edges (pair) With
Astragal for Double
Egress Doors.

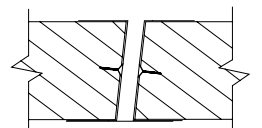

DEA-DE-5
Metal Edges with
Astragal for Double
Egress Door

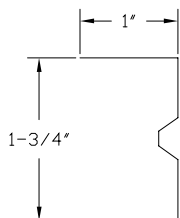
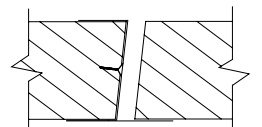

90° Edge
Used on DE-90
DEA-90 & DEA 905

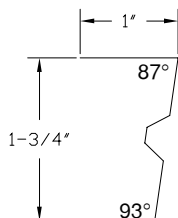

87°/93° Edge
Used on DE,DEA,DEA-5
DE-DE,DEA-DE & DEA-DE-5

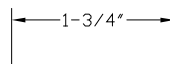

87°/93° Edge
Used on DE,DEA,DEA-5
DE-DE,DEA-DE & DEA-DE-5

PROJECT:

LOCATION:

ARCHITECT:

CONTRACTOR:

CUSTOMER:

DATE: